

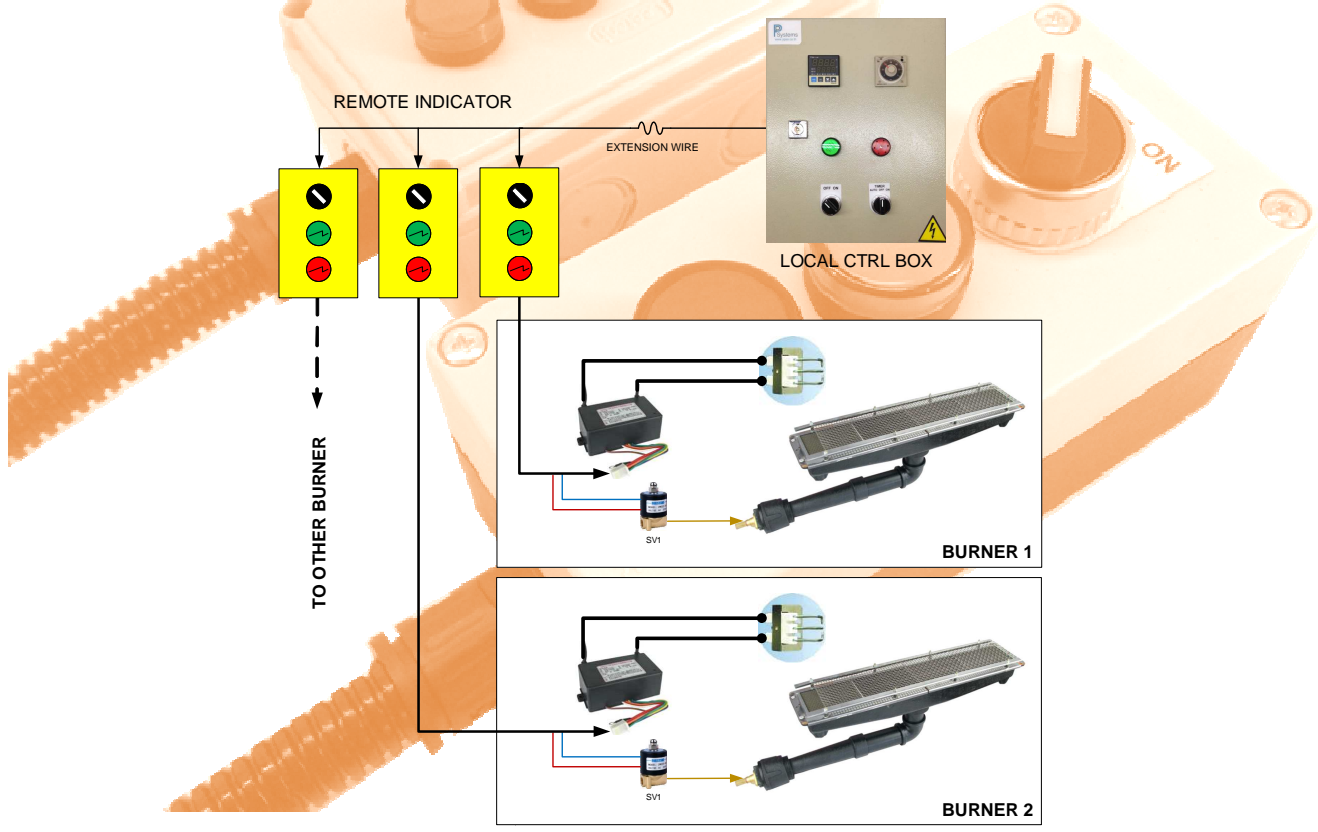

REMOTE INDICATOR | PULSE IGNITION SYSTEM

Remote Indicator helps operator interpretation of burners status and control the particular burners conform to process requirement. Red indicator presents burner Fail operation while Green lamp states burner Working. Operator can suddenly Off - On the individual burner at remote indicator box which not affect to other burners.



	Standard Box	Mini Box
		
Box Size (mm)	70 x 150 x 65	70 x 120 x 50
Indicator Size (mm)	25	16
Material	ABS (Yellow)	ABS (Gray)
Max Operating Temp. (°C)	95°C	95°C
Connecting Method	Cable Gland or PP Conduit	

* Indicator box can be installed even closed to burner or control box according to the instruction.